

UW Health Eastpark Medical Center

4621 Eastpark Blvd

Madison, WI 53718

2nd Floor Conference rooms B2706 and B2708 – North Wing

- Red spaces on the map below indicate the elevators and stairwell that can be taken from the first-floor lobby. There is also an open stairway in the Dr. Howard Bailey Lobby which is in the main entrance between the north and south wing.
- Participants will take a right off the stairs or elevators highlighted below to get them to the entrance of conference room entrance.

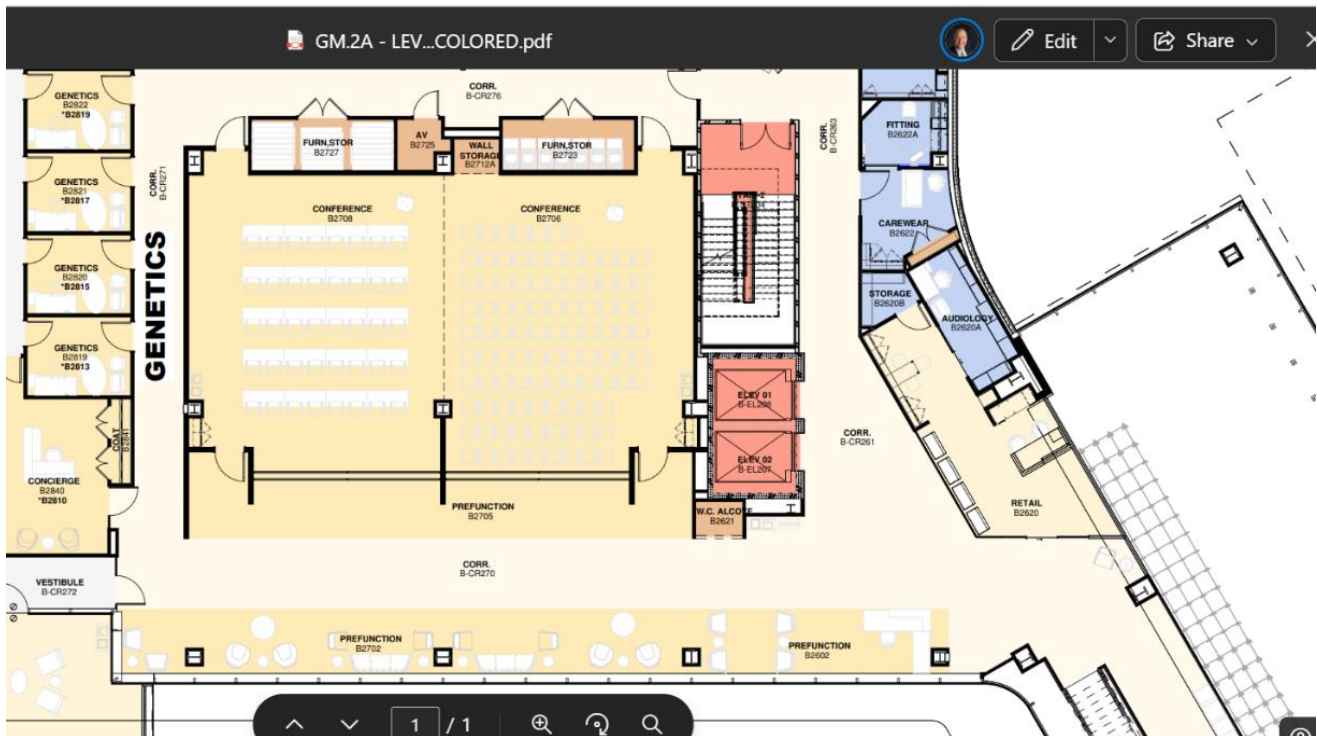

Parking

- Due to our high volume of patients and staff throughout the day our parking availability is very limited on site. For conferences utilizing the Learning Center conference rooms during clinic hours participants will need to park across the street at the Alliant Surface Lot pictured. Please always follow paved paths and do not cut through Alliant Center landscaping to help prevent damage to that property and prairie plantings.

